

117 Oswald Road, Chorlton, Manchester, M21 9GE



JP & Brimelow
ESTATE AGENTS



3 1 2

VIDEO TOUR AVAILABLE A charming & immaculately presented, **THREE DOUBLE BEDROOM**, end terrace property. Located on a highly regarded residential road in Chorlton.

Within walking distance of two fantastic primary schools, Chorlton Village, close to all local amenities including restaurants/deli's/shops on Manchester Road, Longford Park, and the Metrolink station on Ryebank Road, Firswood or Wilbraham Road, Chorlton which gives you direct access into the City Centre and Media City at Salford Quays.

In brief this period, bay fronted property consists of; an entrance hall, a beautiful lounge to the front aspect which benefits from a bay window and log burning stove, a delightful dining room with views and access out into the rear garden, a W.C, and a modern fitted kitchen which is complete with bi-fold doors seamlessly blending the indoor and outdoor areas creating a fabulous entertaining space.

To the first floor you will find three double bedrooms, the principle benefitting from a bay-window and built in wardrobes, a white three-piece shower room completes this spacious property.

The property benefits from gas fired central heating, an alarm system, stripped and varnished floor boards, high ceiling, picture rails and ceiling coving, and an enclosed rear garden.

£550,000





EPC Chart

Energy Efficiency Rating		
	Current	Potential
Very energy efficient - lower running costs		
(92 plus) A		
(81-91) B		
(69-80) C		
(55-68) D		
(39-54) E		
(21-38) F		
(1-20) G		
Not energy efficient - higher running costs		
England & Wales	EU Directive 2002/91/EC 	



Tenure: Freehold Council Tax Band: B

Ground Floor

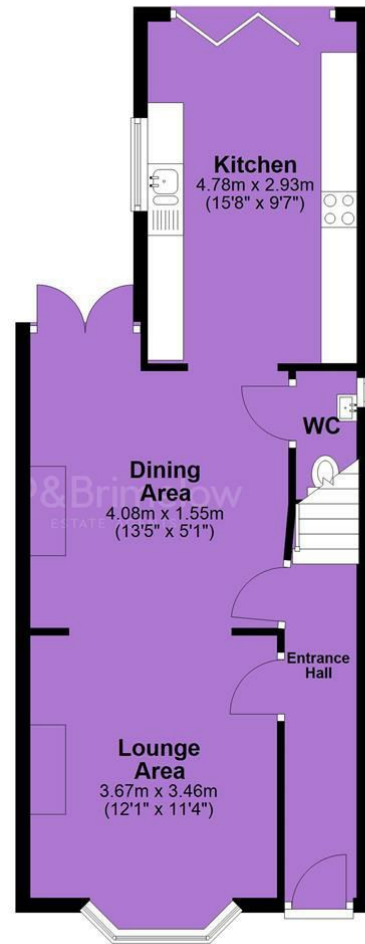

First Floor



JP & Brimelow Estate Agents Ltd
430 Barlow Moor Road, Manchester, M21 8AD
Tel: 0161 8822233
E: sales@jpbrimelow.co.uk www.jpandbrimelow.co.uk



JP & Brimelow
ESTATE AGENTS

NOTICE: JP & Brimelow Estate Agents Ltd for themselves and for the vendors or lessors of this property whose agents they are give notice that:

- (i) the particulars are set out as a general outline only for the guidance of intending purchasers or lessees, and do not constitute, nor constitute part of, an offer or contract;
- (ii) all descriptions, dimensions, references to the condition and necessary permissions for use and occupation, and other details are given in good faith and are believed to be correct but any intending purchasers or tenants should not rely on them as statements or representations of fact but must satisfy themselves by inspection or otherwise as to the correctness of each of them;
- (iii) no person in the employment of JP & Brimelow Estate Agents Ltd has any authority to make or give any representation or warranty whatever in relation to this property.

jpandbrimelowstateagents

@jpandbrimelow

